



LED Module JE-004W-MN Specification

Description



Dimensions (mm)

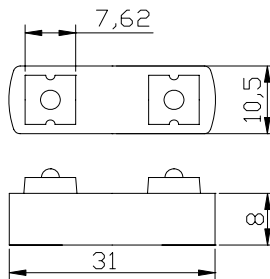

Notes:

1. All dimensions are in millimeters.
2. Tolerance is ± 0.25 unless otherwise noted.
3. Specifications are subject to change without notice.
4. Lead spacing is measured where the lead emerge package.

Specification

Part number	Description	Lens Type	Intensity(mcd)@20mA		Viewing Angle
			Min.	Typ.	2 θ 1/2
JE-004W-MN	white	Water Clear	1200x 2	1400 x2	120° \pm 5

Electrical / Optical characteristics at $T_A=25^\circ\text{C}$

Parameter	Typ.	Max.	Units
Color temperature	9000	12000	K
Forward Voltage	12	12.2	mA
Standing Current	18	20	mA
Power consumption	210	240	mW
Operating temperature	-50°C To +80°C		



LED Module JE-004W-MN Specification

LED Typical Optical/Electrical Characteristics Curves

($T_a=25^{\circ}\text{C}$ Unless Otherwise Noted)

Forward Current vs. Ambient Temperature Relative Intensity vs. Ambient Temperature

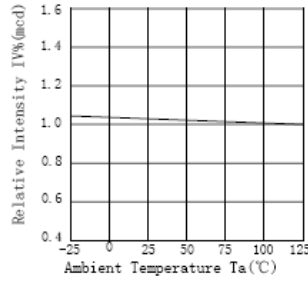
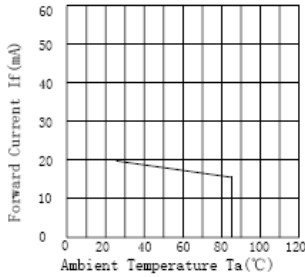

Forward Current vs. Forward Voltage

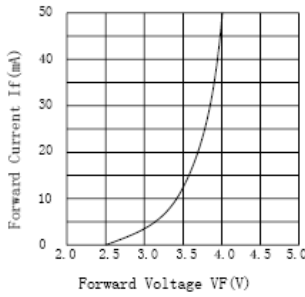

Forward Voltage vs. Ambient Temperature

