

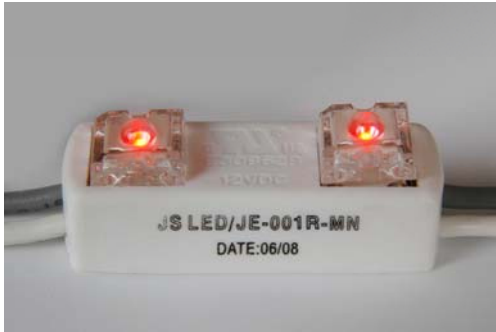

LED Module JE-001R-MN Specification

Description



Dimensions (mm)

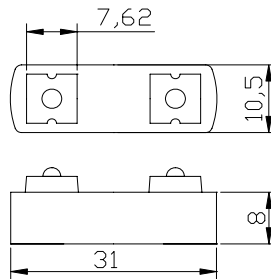

Notes:

1. All dimensions are in millimeters.
2. Tolerance is ± 0.25 unless otherwise noted.
3. Specifications are subject to change without notice.
4. Lead spacing is measured where the lead emerge package.

Specification

Part number	Description	Lens Type	Intensity(mcd)@20mA		Viewing Angle
			Min.	Typ.	2 θ 1/2
JE-001R-MN	Ultra Bright Red	Water clear	1000 x2	1400 x2	100° \pm 5

Electrical / Optical characteristics at $T_A=25^\circ\text{C}$

Parameter	Typ.	Max.	Units
Dominate Wavelength	625	630	V
Forward Voltage	12	12.2	mA
Standing Current	36	38	mA
Power consumption	432	465	mW
Operating temperature	-50°C To +80°C		



LED Module JE-001R-MN Specification

LED Typical Optical/Electrical Characteristics Curves

(Ta=25°C Unless Otherwise Noted)

Forward Current vs. Ambient Temperature Relative Intensity vs. Ambient Temperature

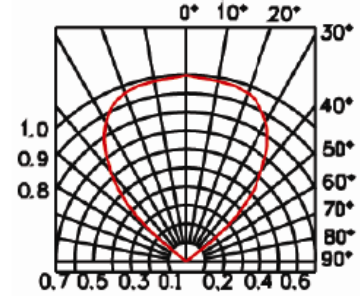
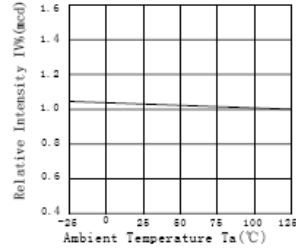
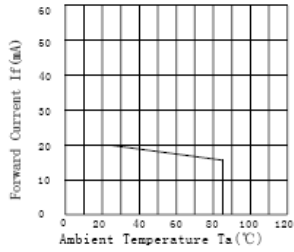

Forward Current vs. Forward Voltage

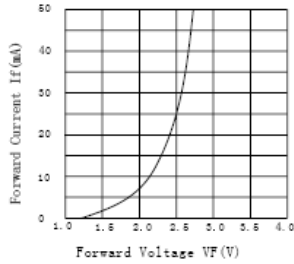

Forward Voltage vs. Ambient Temperature

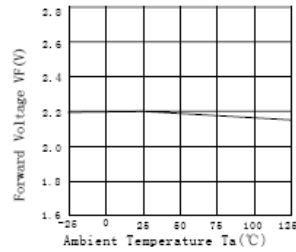

Luminous Spectrum (Ta=25°C) SPECTRAL RADIANCE

